

# Sta-Lok Stud

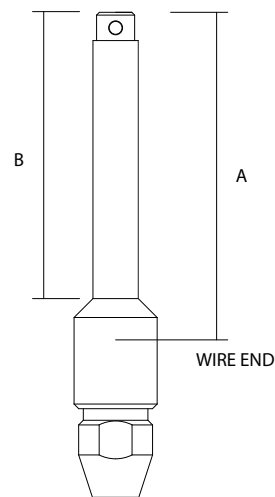
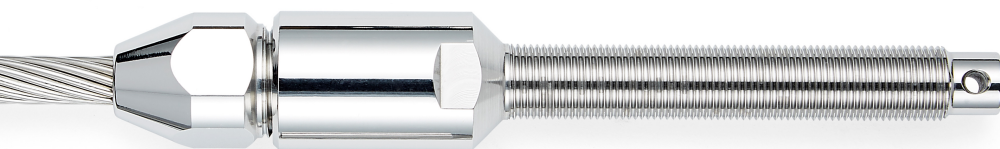

- ▶ Sta-Lok Self Fit Terminal, the reusable alternative to swage
- ▶ Only basic hand tools required
- ▶ Quick and easy to install
- ▶ No pre-measurement needed
- ▶ Guaranteed stronger than wire rope
- ▶ For right hand and left hand lay wire rope
- ▶ Packed for 1x19 wire as standard
- ▶ Manufactured from high specification 316 stainless steel
- ▶ Different wedges are available to terminate 7 strand & compacted wire ropes
- ▶ Supplied with split pin
- ▶ Right hand thread only

REFERENCE	WIRE SIZE		A		B		THREAD	WEIGHT		PRICE	
	MM	INCH	MM	INCH	MM	INCH	UNF	KG	LB	\$	
036-03	3 MM & 1/8"		64.3	2.532	55.6	2.187	1/4	0.020	0.044	57.00	
036-04-1/4	4 MM & 5/32"		65.0	2.562	55.6	2.187	1/4	0.040	0.088	43.50	
036-04	4 MM & 5/32"		67.5	2.656	58.7	2.312	5/16	0.060	0.132	43.50	
036-05-5/16	~	5	~	70.6	2.780	58.7	2.312	5/16	0.080	0.176	51.50
036-05	~	5	~	78.0	3.062	66.7	2.625	3/8	0.080	0.176	51.50
~	136-05-5/16	~	3/16	65.0	2.562	58.7	2.312	5/16	0.080	0.176	51.50
~	136-05	~	3/16	78.0	3.062	66.7	2.625	3/8	0.080	0.176	51.50
~	136-55	~	7/32	84.0	3.312	66.7	2.625	3/8	0.120	0.265	67.00
~	136-55-7/16	~	7/32	85.0	3.343	74.6	2.937	7/16	0.140	0.309	67.00
036-06-3/8	~	6	~	84.0	3.312	66.7	2.625	3/8	0.120	0.265	67.00
036-06	~	6	~	93.0	3.656	74.6	2.937	7/16	0.140	0.309	67.00
~	136-06-3/8	~	1/4	84.0	3.312	66.7	2.625	3/8	0.120	0.265	67.00
~	136-06	~	1/4	93.0	3.656	74.6	2.937	7/16	0.140	0.309	67.00
~	136-06-1/2	~	1/4	94.0	3.687	81.0	3.187	1/2	0.160	0.353	67.00
036-07-7/16	7 MM & 9/32"		95.0	3.750	74.6	2.937	7/16	0.180	0.397	82.50	
036-07	7 MM & 9/32"		97.0	3.812	81.0	3.187	1/2	0.200	0.441	82.50	
036-08	8 MM & 5/16"		98.0	3.875	81.0	3.187	1/2	0.240	0.529	97.50	
036-08-5/8	8 MM & 5/16"		110.0	4.343	95.2	3.750	5/8	0.300	0.661	97.50	
036-10	~	10	~	111.0	4.375	95.2	3.750	5/8	0.360	0.794	139.00
036-10-3/4	~	10	~	129.0	5.062	123.8	4.875	3/4	0.480	1.058	146.00
~	136-10	~	3/8	111.0	4.375	95.2	3.750	5/8	0.360	0.794	139.00
~	136-10-3/4	~	3/8	129.0	5.062	123.8	4.875	3/4	0.480	1.058	146.00
~	136-11	~	7/16	139.0	5.468	123.8	4.875	3/4	0.760	1.676	220.50
~	136-11-7/8	~	7/16	168.0	5.625	139.7	5.500	7/8	0.880	1.940	291.00
036-12	~	12	~	139.0	5.468	123.8	4.875	3/4	0.760	1.676	246.50
036-12-7/8	~	12	~	168.0	5.625	139.7	5.500	7/8	0.880	1.940	291.00
~	136-12	~	1/2	139.0	5.468	123.8	4.875	3/4	0.760	1.676	246.50
~	136-12-7/8	~	1/2	162.0	6.375	139.7	5.500	7/8	0.880	1.940	291.00
036-14	14 MM & 9/16"		170.0	6.687	139.7	5.500	7/8	1.300	2.866	397.50	
036-14-100	14 MM & 9/16"		170.0	6.687	139.7	5.500	1	1.420	3.131	435.00	
036-16	16 MM & 5/8"		171.0	6.750	139.7	5.500	1	1.660	3.660	495.00	
036-19	19 MM & 3/4"		213.0	8.375	171.5	6.750	1 1/8	3.140	6.923	1073.50	
036-22	22 MM & 7/8"		275.0	10.812	227.0	8.937	1 1/4	4.540	10.009	1484.00	
036-26	26 MM & 1"		284.0	11.187	232.0	9.125	1 3/8	5.100	11.244	1740.00	

Metric Only

Inch Only

+1 910 297 2826 | usa@stalok.com